

CITY OF  
**THE VILLAGE**  
OKLAHOMA COUNTY, OKLAHOMA

- INDEX -

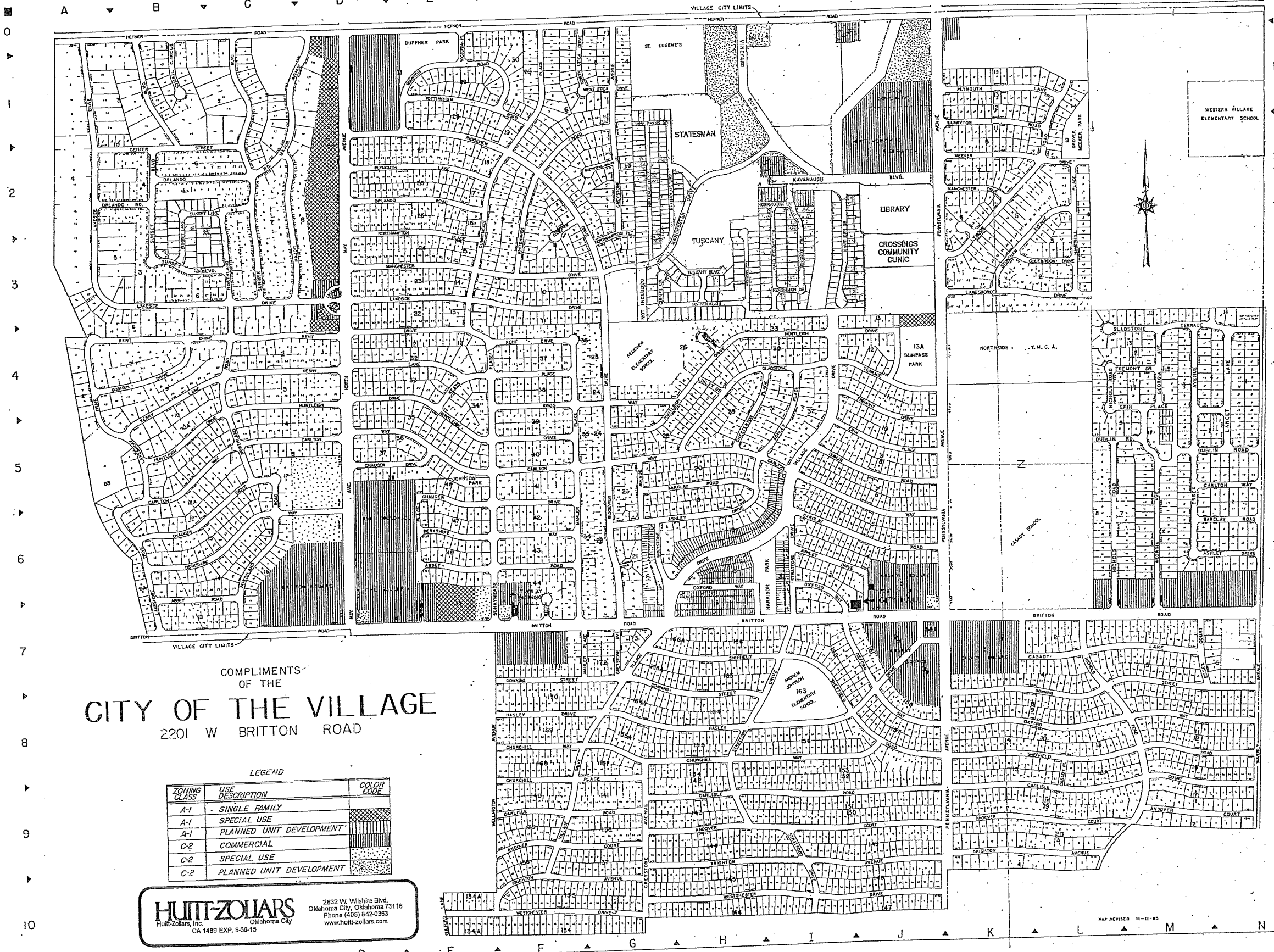

- ABBY RD. BC, EF6
- ANDOVER CT. FN9
- ASHLEY PL. 14-5
- ASHLEY DR. GJ, MN6
- BARCLAY RD. GH5, IJ, MN6
- BARRYTON RD. KL2
- BERKSHIRE WAY BF6
- BRIGHTON AVE. FL10
- BRITTON CIR. F7
- BRITTON RD. AN7
- CASADY PL. L9
- CASADY LANE KM7
- CARLISLE RD. FJ9
- CARLTON WAY BT5, J, MN6
- CENTER ST. AC2
- CHAUCER DR. B, EF6, CE5
- CHESTERTON PL. H5, I4
- CHURCHILL PL. FG9
- CHURCHILL WAY FL3
- COLEBROOK DR. KL3
- DOWNING ST. IJ, LN5
- DUBLIN RD. IJ, LN5
- ERIN PL. IJ, LN5
- ESSEX CT. M7-8
- FREMONT DR. J5, M4
- GEORGIA AVE. M4-7
- GLADSTONE TERR. H5, HJ, LN4
- GUILFORD LANE E10
- GREYSTONE CT. G2
- GREYSTONE AVE. G0-3, 5-10
- HASLEY DR. FJ8, J7
- HAVERHILL PL. L2-3
- HEFNER RD. AN0
- HUNTLEIGH DR. B, EG5, CD, HJ4
- HUNTLEIGH CT. H4
- KENT DR. AF4
- KERRY LANE BE4
- KEATS PL. EF4
- KINGS WAY FH4-5
- LAKESHORE DR. A4-6, B5-7
- LAKESIDE DR. A0-3, B63
- LAKESIDE CIR. D3
- LANGET LANE N4-5
- LANESBORO DR. KL3
- LINLEY DR. H4
- LYNDON RD. K3, L1-2
- MAJOR AVE. C1-3, D0-1
- MAHLER PL. F4-7
- MANCHESTER DG, K4
- MAY AVE. D0-10
- MEEKER DR. KL2
- NORTHAMPTON PL. DE, G3
- NICHOLS RD. L4-10, M8-9
- NORTHLAND RD. C2-7
- ORLANDO RD. AE2
- OXFORD WAY HJ7, JN8
- PENNSYLVANIA KO-10
- PLYMOUTH LANE DE2, KL1
- RIDGEVIEW DR. DE1, EF2, G2-7
- RIDGEVIEW CIR. G6
- RIDGEVIEW CT. F3
- SHEFFIELD RD. GI7, IN8
- STRATFORD DR. H8-9, I6-10
- STONEHAM AVE. KL3
- SUNNYMEAD PL. E3-4, F0-7
- SUNRISE BLVD. C0-3
- SURRY PL. E5-7
- TOTTINGHAM RD. EF1
- UTICA DR. (N&W) G0-1
- VICTORIA PL. E0-1
- VILLAGE DR. F8-10, G7, H6, I4
- WAVERLY AVE. N4-9
- WELLINGTON F7-10
- WESTCHESTER EJ10
- WINSTON RD. EF1
- WHITEHAVEN RD. F2-3, GI-2

COMPLIMENTS  
OF THE  
**CITY OF THE VILLAGE**  
2201 W BRITTON ROAD

LEGEND

ZONING CLASS	USE DESCRIPTION	COLOR CODE
A-1	SINGLE FAMILY	[Symbol]
A-1	SPECIAL USE	[Symbol]
A-1	PLANNED UNIT DEVELOPMENT	[Symbol]
C-2	COMMERCIAL	[Symbol]
C-2	SPECIAL USE	[Symbol]
C-2	PLANNED UNIT DEVELOPMENT	[Symbol]

**HUITT-ZOLIARS**  
Huitt-Zoliars, Inc. Oklahoma City  
2832 W. Wilshire Blvd.  
Oklahoma City, Oklahoma 73116  
Phone (405) 842-0363  
www.huitt-zoliars.com  
CA 1489 EXP. 5-30-15

- INDEX REVISION -
- BRITTON CT. F7
  - CARLISLE CT. KN9
  - ESSEX AVE. M4-6
  - GOSHEN DR. AB4
  - KAVANAUGH BLVD. IJ2
  - QUAIL CIRCLE B0-1
  - SUNSET BLVD. B0-3
10. REVISED: 12/26/13  
REVISED: 7/17/91  
REVISED: 9/07/94